

QUALITY BORE REPAIR SOLUTIONS

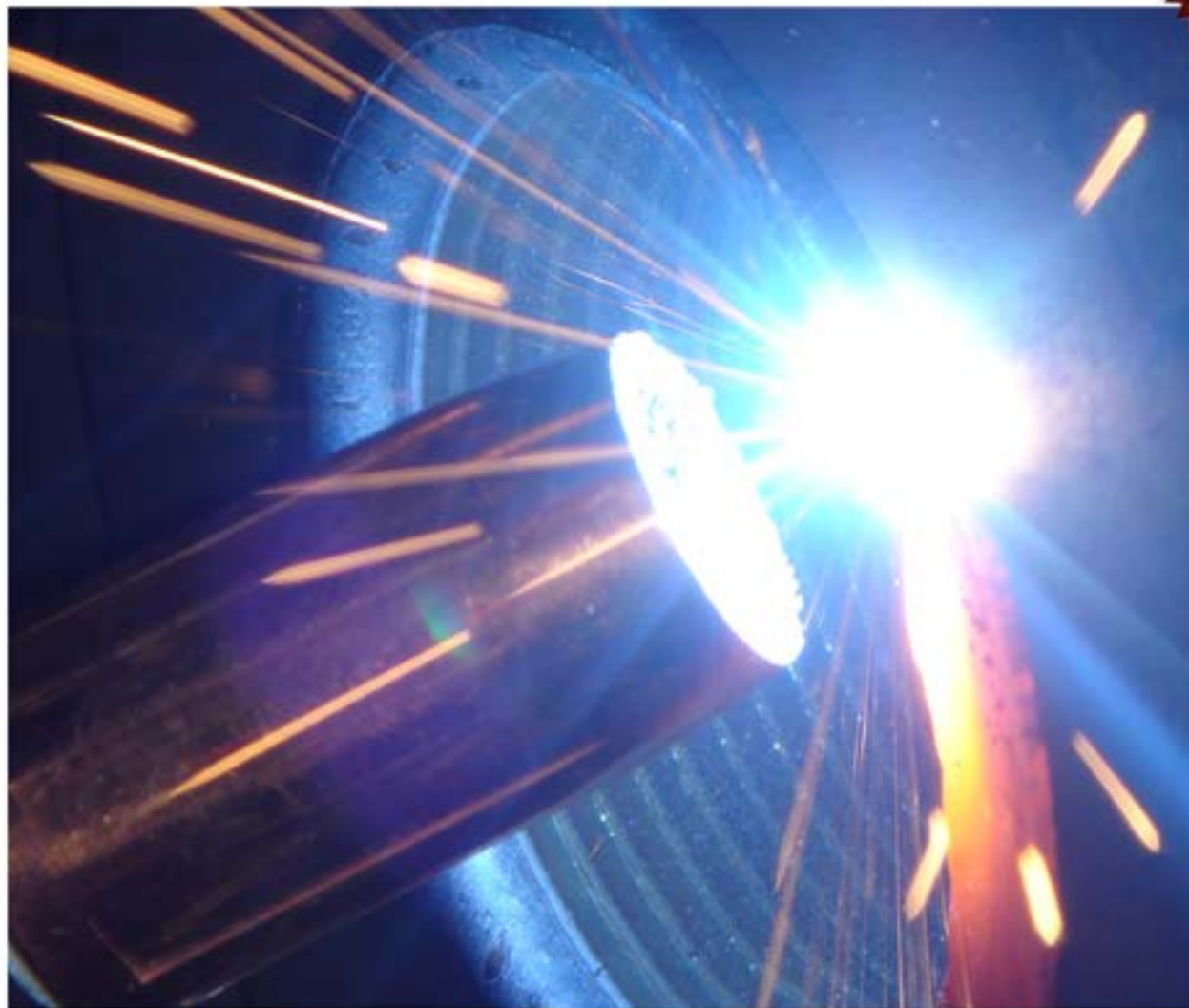

■ Professional bore welders, boring bars and accessories



Value - Experience - Service - Support

www.borerepair.com - 603-835-2409 int'l - 800-650-1005 USA/CAN

BORE REPAIR MADE EASY



Introducing our elegantly simple, ultra reliable bore welders and boring bars for top quality bore repairs on all types of machinery.

■ The BOA-408i Bore welder

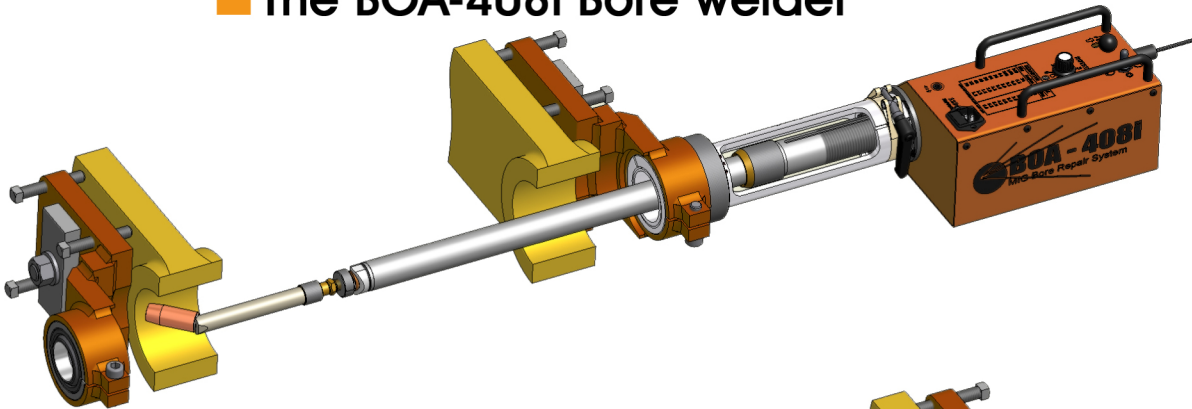

■ The BOA-M1 Bore welder

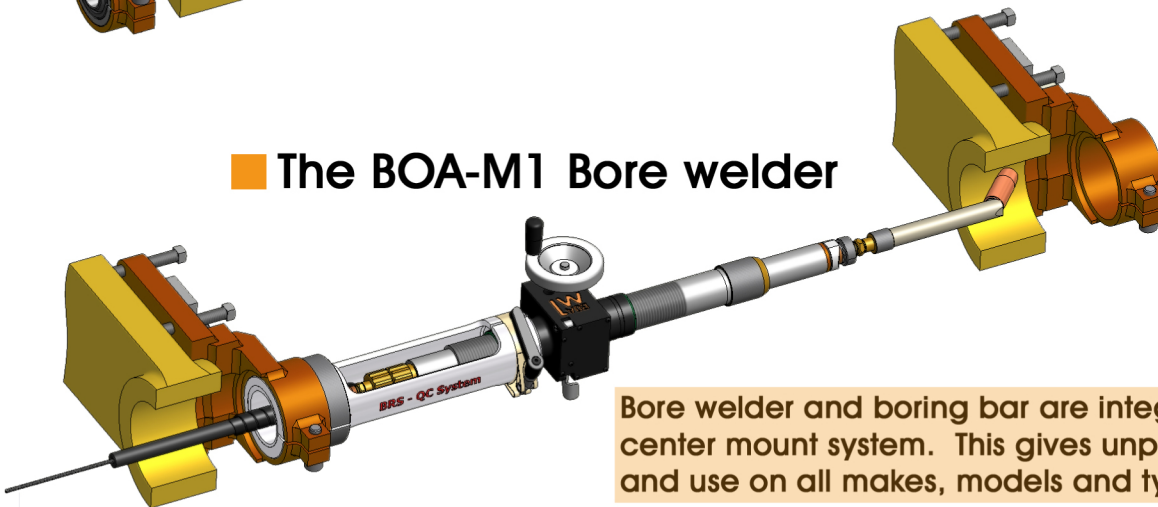

Bore welder and boring bar are integrated with our center mount system. This gives unparalleled ease of setup and use on all makes, models and types of equipment.

■ BOA-C45 Boring Bar

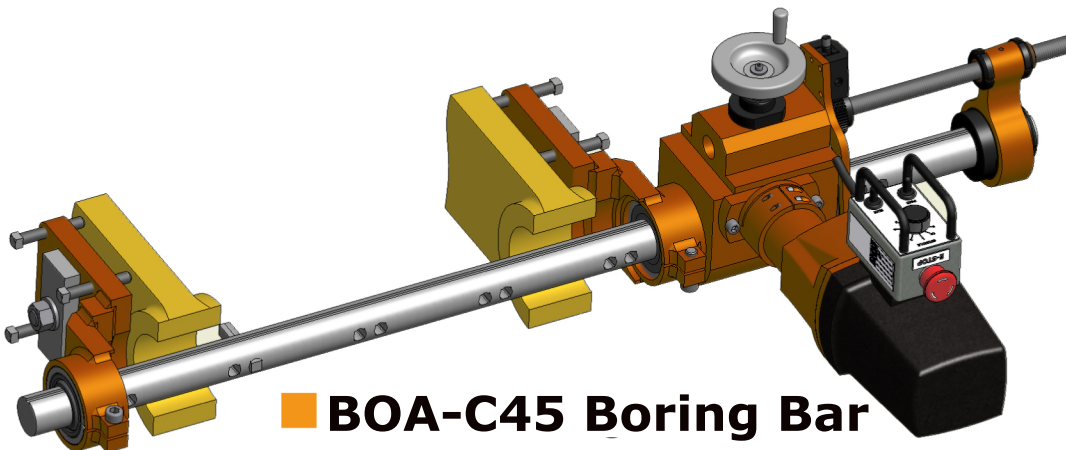

The professional's choice...worldwide.

Value — Experience — Service — Support

www.borerepair.com - 603-835-2409 Int'l - 800-650-1005 USA/CAN

BORE REPAIR MADE EASY



THE BEST OR NOTHING

Bore Repair Systems, Inc. equipment is designed by users, for users. This is why our systems are the only portable bore repair systems that are built with the TOP 10 most valuable features in the industry.

TOP 10 LIST OF MOST VALUABLE FEATURES FOR EASY BORE REPAIR

- #1 - Pass-thru drive design on both bore welder and boring bar - you will not have to re-mount the boring bar or welder drive when working on widely spaced bores on heavy equipment
- #2 - Telescoping and reversible welding gun - no clumsy welding gun extensions are required when welding multiple inline bores
- #3 - Center-mount bore welder to boring bar interface - simply attach your bore welder directly on centerline of boring bar with no centering or realignment needed
- #4 - Mechanical axial feed can never get out of calibration - no chance of weld penetration problems with a BOA
- #5 - Unique standard adjustable welding gun has the largest diameter range range in the industry - no need for multiple welding guns
- #6 - Welding gun nozzles are electrically isolated and will not "arc out" when making contact with bore wall
- #7 - Standard welding guns utilize inexpensive and easy to change thread-on welding tips and nozzles
- #8 - Dual tool ports on boring bars - enables easy, accurate bore diameter measurements and tool adjustments, without having to remove bar or cutter
- #9 - Mechanical feed system on all boring bar drives - fixed or variable feed rates run in direct conjunction with bar rotation providing smoothest possible surface finishes
- #10 - Infinitely adjustable rotation speeds on boring bar drives enable use of wide variety of cutters including carbide, high speed steel and snap-ring cutters

CUSTOMER COMMENTS:

>Rick from Smitty's writes:

"We absolutely love our Bore Repair System. We've been doing lots of ID's and OD's and it just works great!"

>MJ McCarroll writes:

"I would not trade my BOA bore welder for anything, it is that good."

>Turner Diesel writes:

"I am amazed at how great our BOA bore welder works, it's been a real asset to our business."

>Gary from Clark's Repair writes:

"Man I love my Bore Repair System, it just works great."

>Dan A. writes:

(After 5 years of ownership) "I use my BOA bore welder all the time and am considering adding a second machine soon...It has been an excellent addition to my business and always works for me and does a great job."

>Joe L. writes:

"I purchased one of your BRS3 welding/boring systems from you and just wanted to let you know that it is everything you said it was, I am very pleased with it, and thank you."

>Peter M. writes:

"The BRS3 boring and welding system I purchased from you works great. You have a very good product."

- All of us at Bore Repair Systems, Inc. look forward to working with you and helping you with all your bore repair needs.

The professional's choice...worldwide.

Value — Experience — Service — Support

www.borerepair.com - 603-835-2409 Int'l - 800-650-1005 USA/CAN

SETUP OF BORE REPAIR SYSTEM



#1. Center boring bar using centering kit & attach supports



#4. Insert BOA bore welder into support using interface kit



#2. Insert boring bar drive and motor



#5. Attach BOA bore welder to your MIG feeder and apply weld



#3. Machine the bore to clean and prepare for welding



#6. Slide boring bar back through supports and machine bore to size



Time is money and our integrated BRS systems saves you both. Cut welding time by 80% and machining time by 50% by using reliable, affordable Bore Repair Systems' integrated bore welder and boring bar systems.

The professional's choice...worldwide.

Value — Experience — Service — Support

www.borerepair.com - 603-835-2409 Int'l - 800-650-1005 USA/CAN

Standard Boring Bar Setup

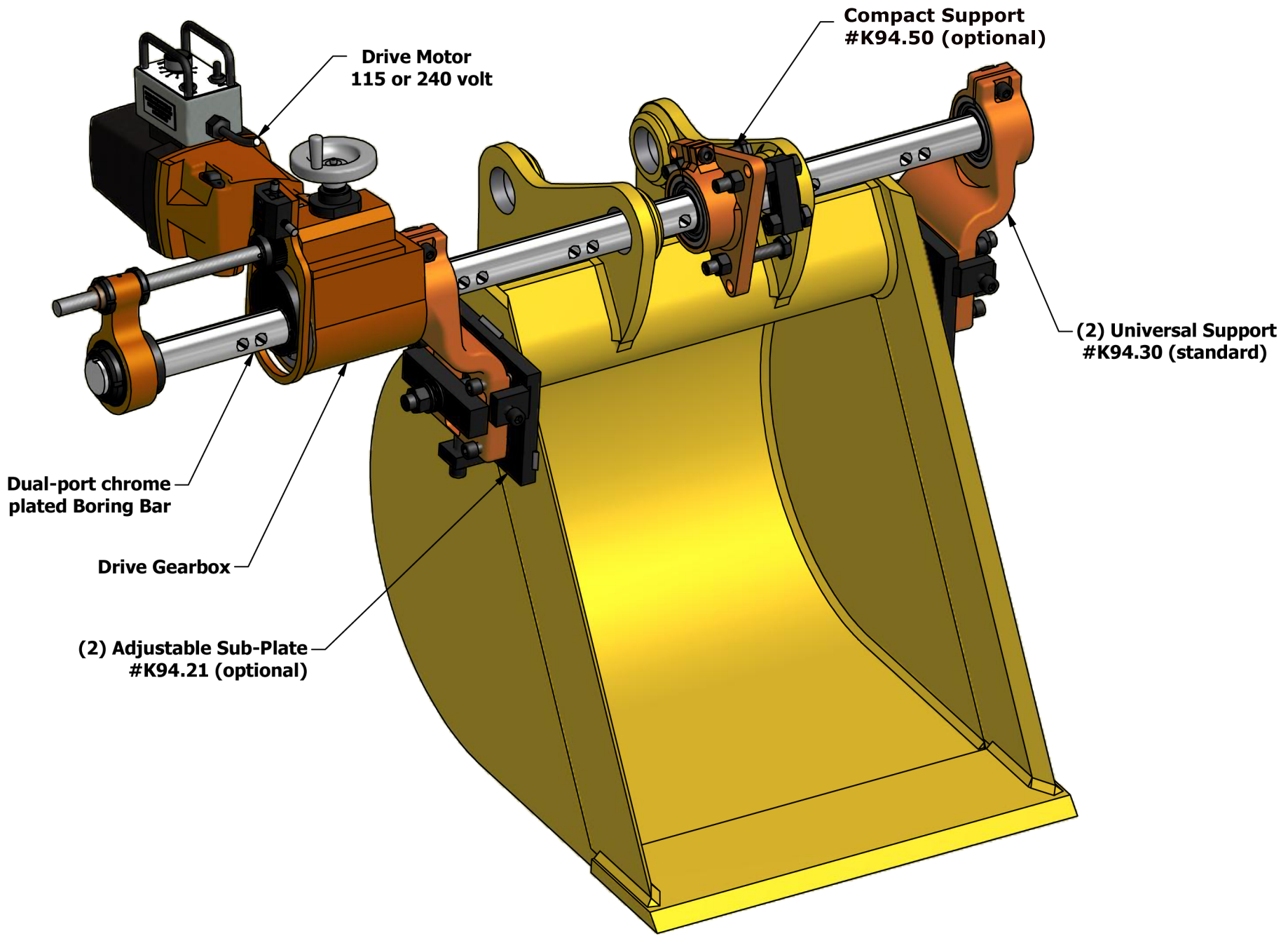

Inverted Boring Bar Setup

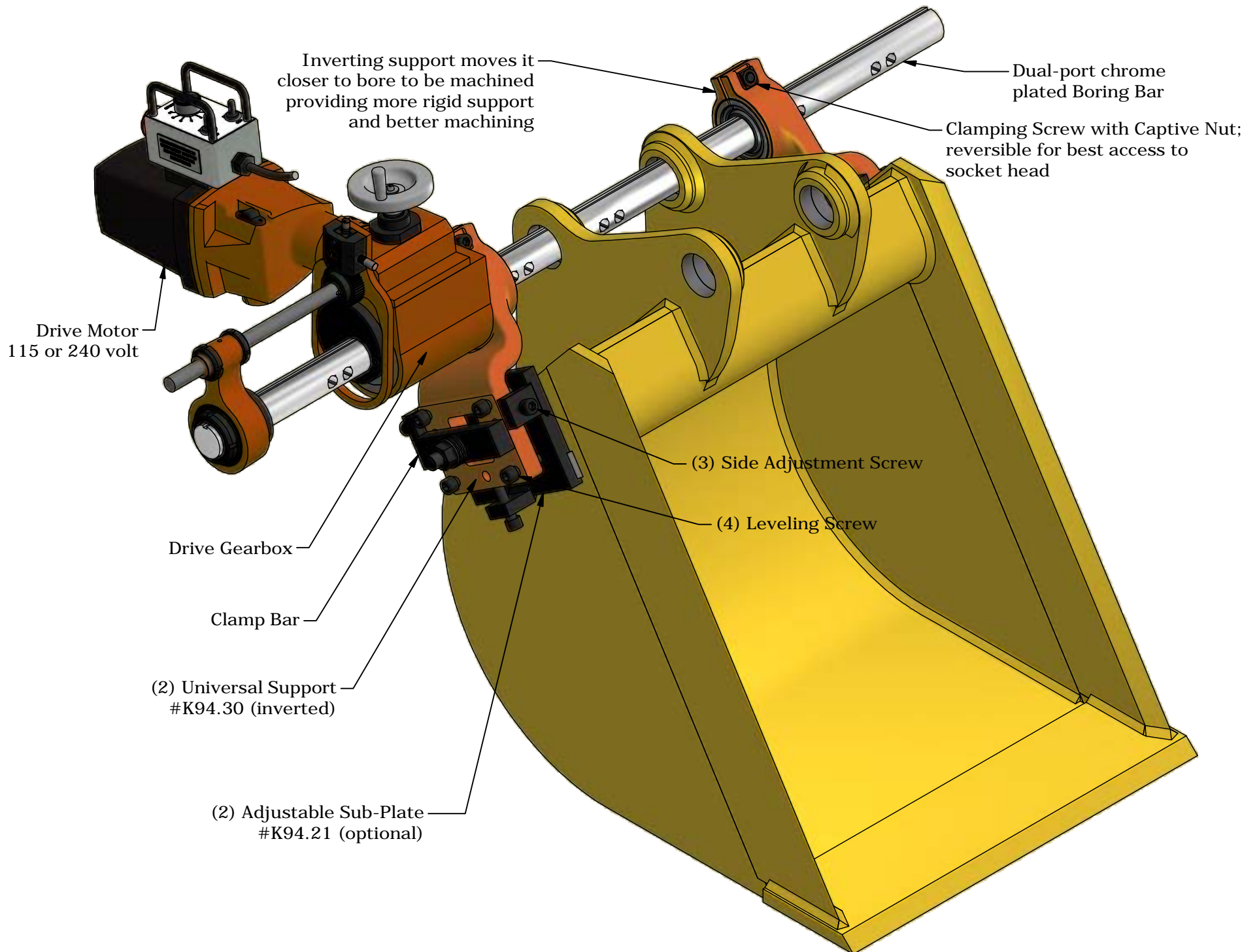

Bore Welder Center Support

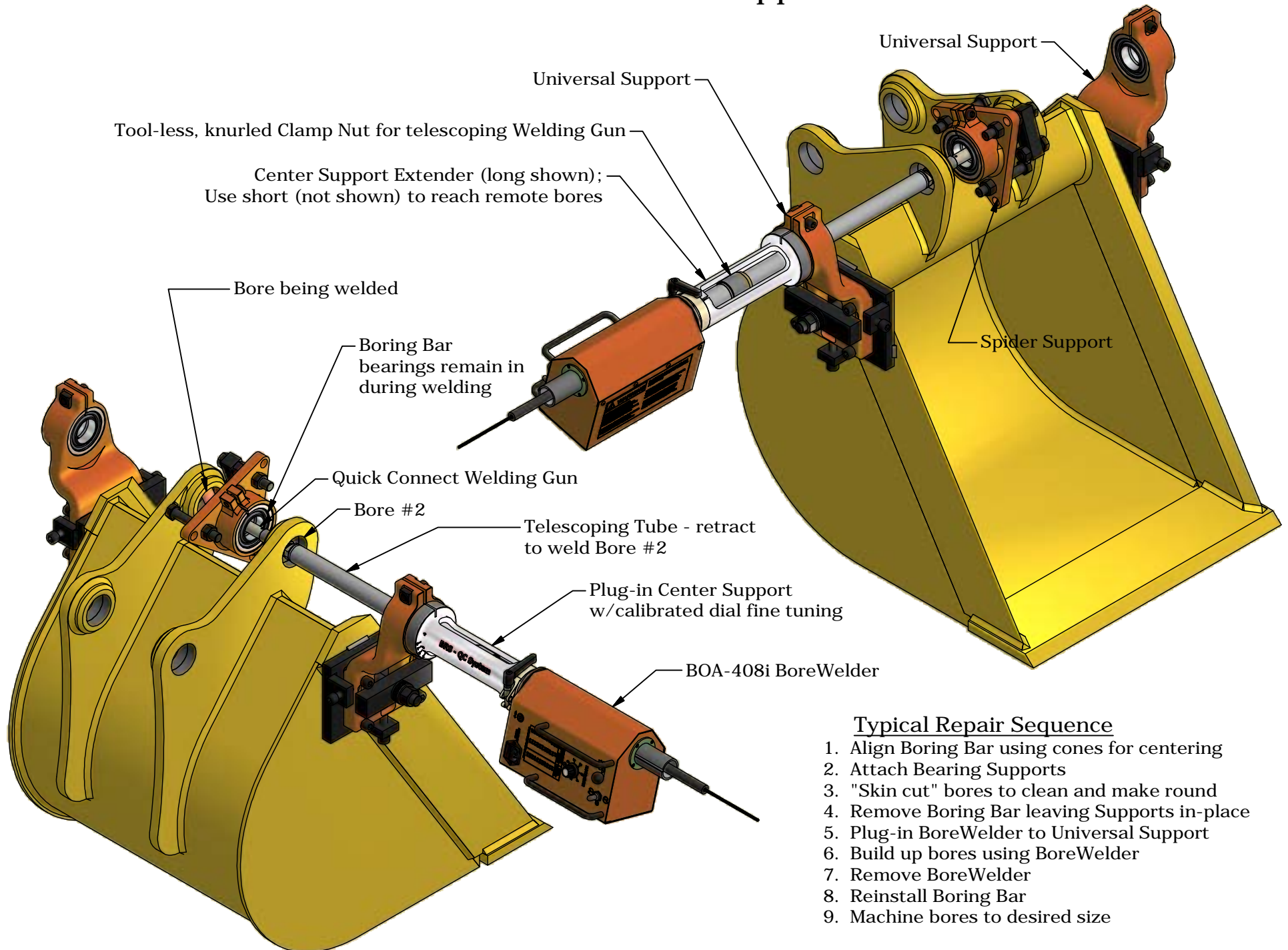

Typical Repair Sequence

1. Align Boring Bar using cones for centering
2. Attach Bearing Supports
3. "Skin cut" bores to clean and make round
4. Remove Boring Bar leaving Supports in-place
5. Plug-in BoreWelder to Universal Support
6. Build up bores using BoreWelder
7. Remove BoreWelder
8. Reinstall Boring Bar
9. Machine bores to desired size

BarDrill Setup

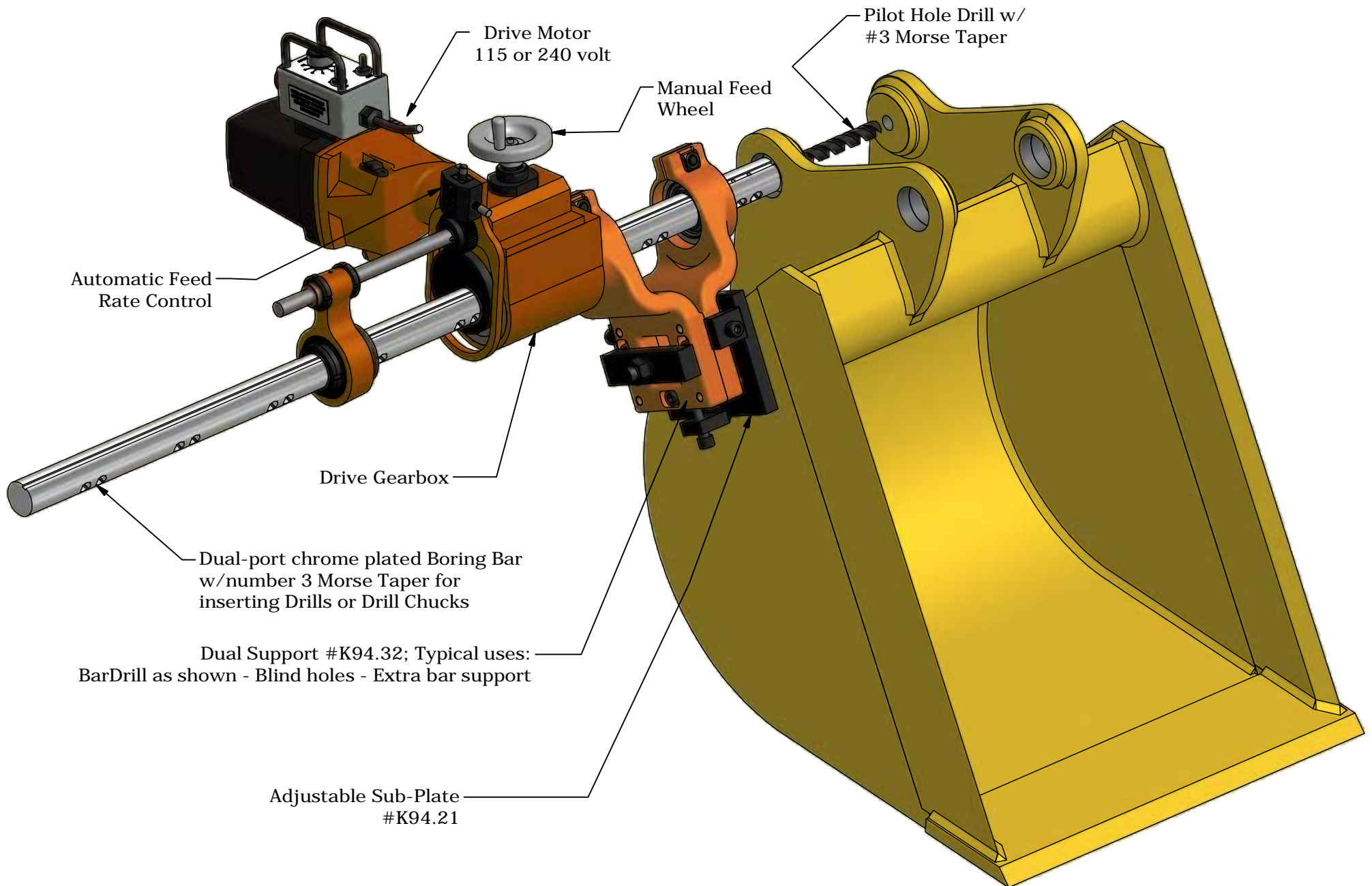

Universal Support Kits K94.30 & K94.32 Mount Configurations

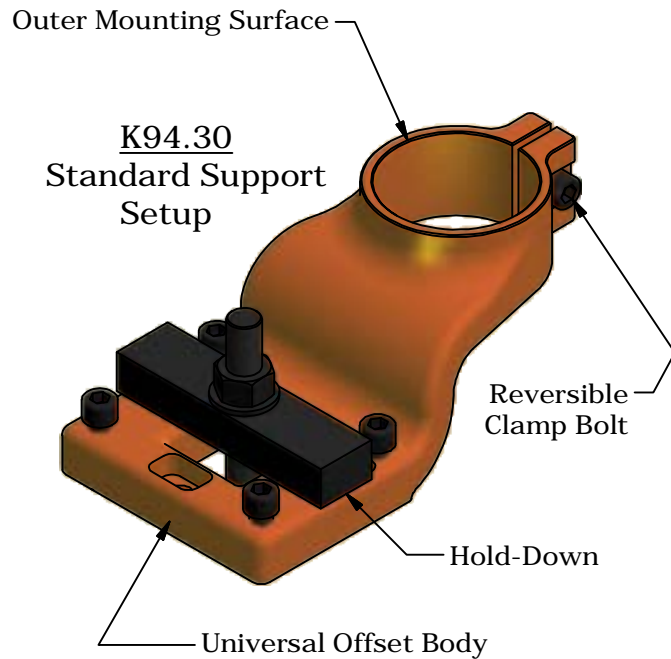

TYPICAL USES/FEATURES

- Standard Single Support
 - Most outboard locations where bore is near mounting surface
 - Mount drive on either Outer or Inner Mounting Surface
 - Supports Spherical Bearing

- Inverted Single Support
- Use when bore is inboard from mounting surface
 - Mount drive on either Outer or Inner Mounting Surface
 - Supports Spherical Bearing

- Double Support
- Use when extra bar stiffness is needed, such as blind holes or bores located far from support
 - Can be used as a drill press with special Morse Taper Bar
 - Mount drive or bearing at either clamping location

- Reversible Clamp and Joining Bolts
- Allows access to bolt head from either side
 - Clamp Nut captive on either side so second wrench not needed

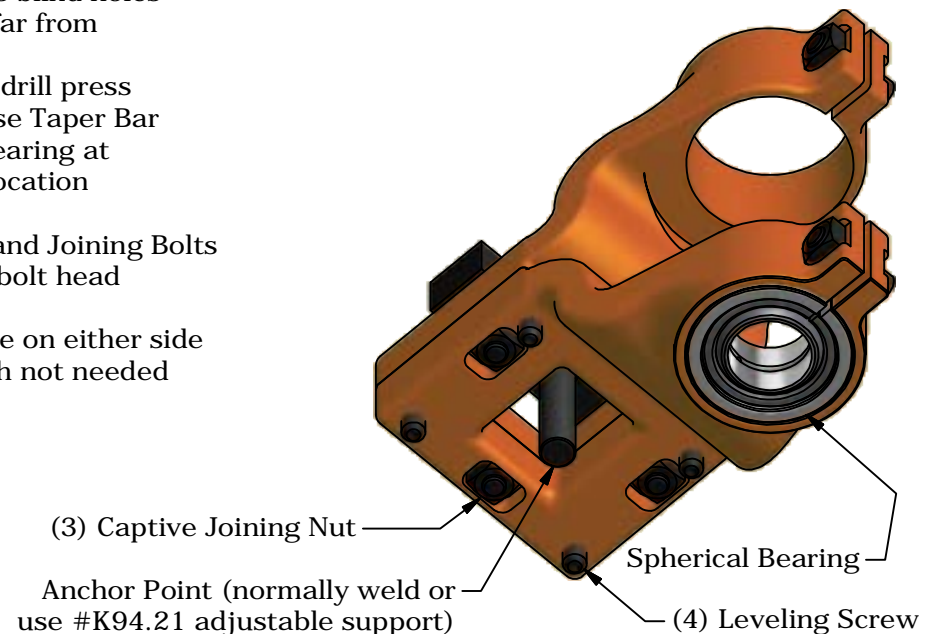
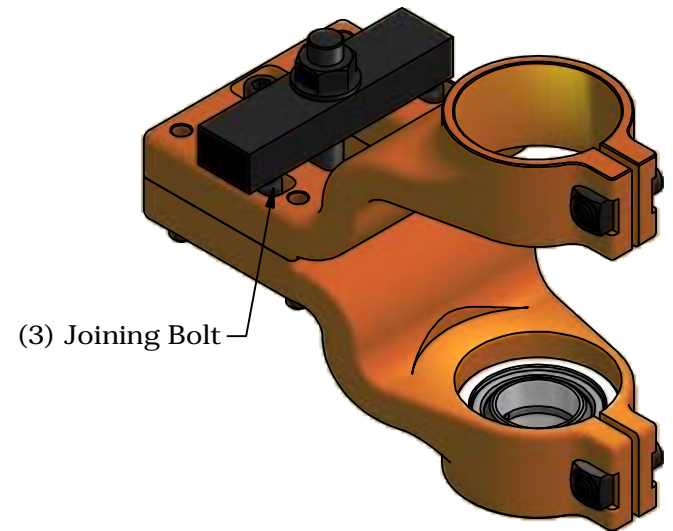
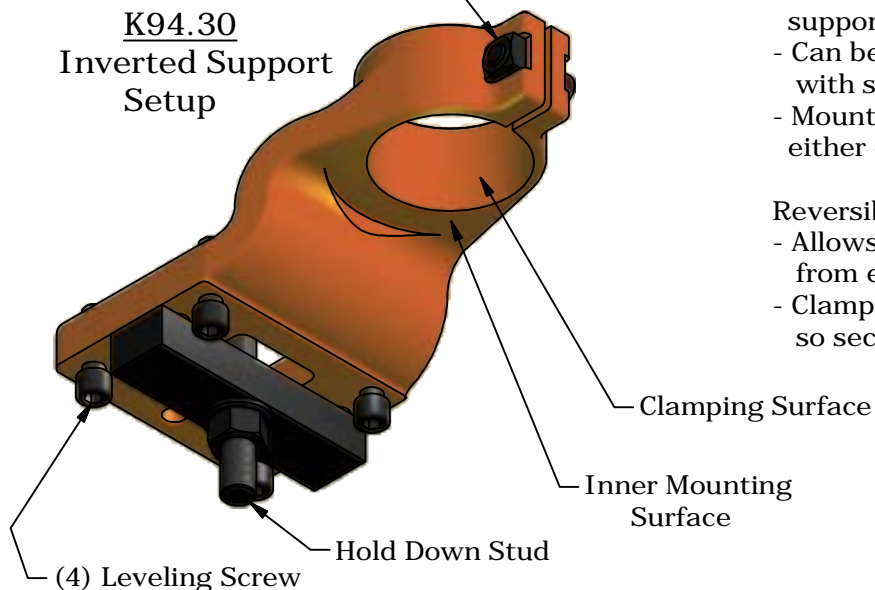

BOA C45 Line Bore Kit

For machining bore diameters up to 14" (356mm)



The Bore Repair Systems, Inc. BOA-C45 portable line boring systems are simple to use in the field and shop, rugged and extremely accurate. From the C45 precision hardened and chromed boring bars with staggered dual tool ports and morse taper end to the unique external ratcheting, variable rate cam feed, tuneable ID bar support bearings and standard cone tightening system, the BOA-C45 line boring system will provide you with the features needed to quickly and accurately repair worn bores from under 1" to over 10" diameter on all types of equipment in a variety of industries. And while the BOA-C45 series line boring system features a powerful 3.3hp reversible, variable speed motor, the standard bar drive is a compact 15" wide* including the feed screw. The C45 system also features the popular pass-through drive design allowing placement between bores, in tight-access spots, or to be used on tricky "blind bore" jobs or jobs where there are multiple bores in a line. The unique, dis-engagable feed arm allows simple tool repositioning without removing the tool from the bar....a feature not possible with old-fashioned traditional end-drive boring systems. Add one of Bore Repair's automatic bore welding systems for maximum efficiency and productivity on all your bore repair jobs.

BOA-C45 boring system includes the following standard equipment:

The BOA-C45 standard boring bar package machines bores from 48 to 254mm (1.9" to 10") in diameter.

- 3.3Hp reversible, adjustable drive motor (120v or 240v)
- 1.75" x 72" long chrome, dual-tool ported boring bar
- (2) one-arm adjustable boring bar / boring bar gearbox / bore welder drive supports including (2) bearing inserts
- Sharpened cobalt/HSS cutting bit (1/2") for ID and faces
- Quick-change feed screw
- Mounting plate kit for use with one-arm supports
- Star-drive motor to gearbox interface
- Pass-through, reversible, variable axial feed boring bar drive gearbox
- Centering cone package with tightener kit
- Extended range boring head
- Diamond plate carry/storage case
- Tool kit including allen wrench set and nut driver
- Protective sleeve with thread-off ends for boring bar
- Metric/Imperial scale
- Setup manual with step-by-step photos
- One-year warranty
- Upgrade from electric to hydraulic drive any time
- Free training

BOA-C45 boring system optional accessories:

- BOA-408i and BOA-M1 integrated bore welding kit
- Large range bore head (for cutting to 356mm (14") bores
- Small bore kit (for cutting down to 35mm (1.4") bores
- Micro bore kit (for cutting down to 25mm (1") bores
- Internal automatic snap-ring groove cutting system
- Automatic, low-profile face-machining kit
- Manual compact "plunge" face-machining kit
- Internal through-bar bore measuring gage kit
- Precision bar-mounted tool bit adjusting kit
- Bar coupler kit for joining two bars for long-span work
- Various length feed screws with quick change feature allowing un-interrupted long-span cutting and easy setup in tight spaces
- Compact and Vari-mount support options

Model BB6 Line Bore Kit

For machining bore diameters up to 24" (635mm)



The Bore Repair Systems, Inc. model BB6 portable line boring system is simple to use, rugged and extremely accurate. From its precision hardened and chromed boring bars with dual tool ports to the adjustable, remote-mountable mechanical feed gearbox, tunable ID bar support bearings and standard cone tightening system, the BB6 line boring system will provide you with the tools needed to repair worn bores from under 1.4" to over 24" diameter on all types of equipment with ease and precision. And while the BB series line boring system features a powerful 3.3hp reversible, variable speed motor, the bar drive is a compact 12" wide. The BB6 system also features the popular pass-through drive design allowing placement between bores, or to be used on tricky "blind bore" jobs or on jobs where there are multiple bores in a line, the feed arm allows simple tool repositioning without removing the tool from the bar....a feature not possible with traditional end-drive boring systems. Add one of Bore Repair's automatic bore welding systems for maximum efficiency and productivity on all your bore repair jobs.

Model: BB6

Bore machining package—for machining bores from 1.4" to 24" in diameter. (36mm to 610mm) (Order #K09.15) Package (shown in photo above) includes:

- 3.3Hp reversible, adjustable drive motor (120v or 240v)
- Pass-through, remote mount adjustable feed gearbox
- (3) boring bar / boring bar drive supports
- Setup sleeve for support alignment
- Sharpened cobalt/HSS cutting bits (1/2" and 3/8")
- (2) bar kit, 6' x 2.25" and 1.25" diameter with reducers
- Pass-through, reversible boring bar drive gearbox
- Centering cone package with tightener clamp
- (6) Extended range boring heads
- Necessary wrenches
- Custom wooden shipping / storage case
- Adjustable feed travel stop arm

TIP: Don't need to machine any bores smaller than 2.5"? Bore Repair Systems, Inc. also offers the BB6 Boring system is also available without the small (1.25") bar package.

Popular accessories to further enhance your BB6 line boring system include: #K96.18 snap-ring machining kit, #9260 face machining head, #K94.21 adjustable base plate kit, #K92.10 ID bore measure kit and #K93.26 digital tool bit adjuster kit and bore welding package. Hydraulic drive option is also available.



CE approved ✓

Pat. 6,137,076 Pat. 6,448,531 Pat. 6,737,608
Pat. 6,284,995 Pat. 6,486,438

www.BoreRepair.com



2025

PO Box 59
Alstead, NH 03602 USA

Tel: (603) 835-2409
Fax: (603) 835-2609

(popular choice for most heavy equipment bore repair jobs)

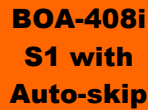

The BOA-408i automatic bore welding system is designed for users who demand durability, ease of setup and precision without unnecessary complication.

Coupled with one of Bore Repair Systems' boring bars and new Center Support System, it will provide you with a means of repairing worn bores on all types of equipment in the fastest, most efficient way possible. Awarded numerous design patents, owners of our BOA systems quickly realize they made the right decision when choosing Bore Repair Systems' products. The BOA systems are the simplest to set up, the simplest to use and offer the highest levels of precision all at very reasonable prices.

The BOA-408i is conveniently offered in 5 packages, ranging from the basic BOA-408i S1 for internal bore buildup to the fully loaded BOA-408i S5 which features all the upgrades available including long stroke, auto-skip, face welding, outside diameter welding and even a BOA-M1 compact bore weld drive head and gun assembly.

The BOA-408i bore welder system is also offered in complete, turnkey kit form with integrated boring bar system. See our BRS2-BRS7 integrated bore welding and machining systems.

Already own a boring bar system but need to automate your bore welding process? The BOA-408i is for you too. Any BOA-408i system is available with boring bar interface kits to fit any brand boring bar system that you may now own.

Bore Repair Systems, Inc. offers many convenient purchase plans including rent-to-own and lease finance options. Contact us today at 603-835-2409 or visit our website at www.borerepair.com.



BOA-M1 Bore Welding System

(our most compact and affordable bore welding system)



The BOA-M1 basic bore welding system is Bore Repair Systems' most compact and affordable bore welder. The welder drive and spindle assembly will fit nearly anywhere at just under 280mm (11.0") long.

The BOA-M1 basic package is extremely versatile. With standard components, it can reach bores nearly 610mm (24") away from its' mount location, or bores over 1.2m (48") apart from one another when mounted between bores.

The BOA-M1 design is elegantly simple and extremely durable, very easy to set up and operate. It utilizes the same gun and conduit system as the BOA-408i so parts are interchangeable.

While the BOA-M1 bore welding system is a popular choice with our existing BOA-408i and BOA-550HD customers who are interested in a second bore welder that can fit in tight, restricted access bore repair jobs, it is also very popular with our new customers who are just starting out who need a bore welder that will give top quality professional results at the lowest possible entry price.

The BOA-M1 comes complete with a hand feed wheel and rotation speed timer with chart. This ensures smooth, even weld bead application every time. The BOA-M1 can also be easily driven automatically with a basic hand drill or for maximum versatility you can add our automatic stepper drive kit.

Please call us today at 603-835-2409 or visit our website at www.borerepair.com. Several purchase and leasing options are available.

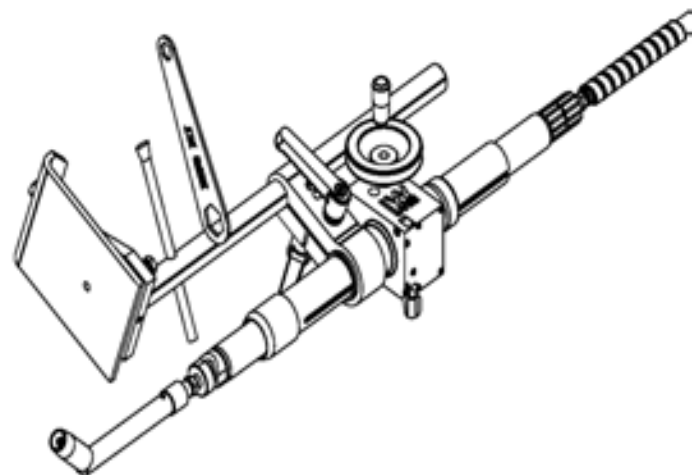

ONE-STEP INTEGRATED COMPLETE BORE REPAIR SYSTEMS

Model: BRS2c, BRS3c and BRS4c—(Typically used for heavy equipment bore repair)



**BOA408i
Borewelder**



**BOAC45
Boring bar**

*optional equipment shown

The Bore Repair Systems, Inc. BRS2c, BRS3c and BRS4c integrated line boring bar and bore welding machines are our most popular selling packages. The bore welder and boring bar feature the popular, mount anywhere pass-through drive systems. On bores where there may be restricted access, or bores that are spaced far apart, the pass-through drive design gives you the flexibility to mount where it makes the most sense, such as between the bores. On jobs such as payload lift arm bores, the BOA-408i can be center-mounted and can weld out either end of the machine with one simple operation, without ever losing system center...this is unique to the BOA-408i design. On blind bores, our systems do not require special cumbersome remote mounting kits or various length bars because with our pass-through design the excess bar simply comes out of the back end of the machine. The BRS packages share one mount for boring and welding which allows fast setup and rapid transitions from boring to the welding process.



MODEL: BRS2c Bore welding & machining package—for 1.8" to 10.0" dia repairs

#K05.109902 Package (shown above) Includes:

- Bore welding head, 110v or 220v drive with variable feed direction, rate and RPM—premium pass-through design
- Extendable, reversible welding shaft with 90" total extended reach from bore to bore (expandable)
- 10' 150amp welding conduit with universal end (hi-amp upgrades are available)
- Spare welding nozzle, tip and diffuser assortment
- Arc-resistant heatsink style adjustable welding head with quick-connect
- Welding gun extender assembly with quick-connect
- Setup manual with exploded views and graphics
- Remote weld trigger for partial bore welding or skipping over no-weld areas
- Fully 360 degree adjustable mounting system enabling control placement where it is most convenient
- Boring bar drive, 3.3HP 110v or 220v drive with variable feed direction and RPM—premium pass-through design
- 72" long x 1.75" dia. Bar with dual 1/2" tool ports—enabling easy bore measurements w/out tool removal
- Centering kit (solid steel cones) with unique one-person centering cone spanner tightening system (for 1.8"-10.0")
- Spherical self-aligning bar support bearing and bar/machine support (adjustable)
- Bore welder to boring bar interface package enables bore welder to mount directly to boring bar bearings or support
- Setup sleeve for easy machine support setup
- Quick change feed screw system with over-travel safety
- Boring bar tool extender for sturdy tool holding when machining larger bores
- Corrosion-resistant materials used throughout both boring and welding system for years of shop and field reliability

MODEL: BRS3c Bore welding & machining package—for 1.4" to 10.0" dia repairs

#K05.109903 Package Includes all items above plus:

- 72" long x 1.25" dia bar with dual 3/8" tool ports + tooling
- Centering cone & bushing kit for 1.75" to 1.25" conversion

MODEL: BRS4c Bore welding & machining package—for 1.0" to 10.0" dia repairs

#K05.109904 Package Includes all items above plus:

- 48" long x .875" dia bar with 1/4" tool ports + tooling
- Centering cone & bushing kit for 1.75" to .875" conversion

#1 Seller

ADD at any time: Large bore welding heads, extended range centering rings, high-amp consumables, outside diameter & face welding & machining.



CE approved ✓
Pat. 6,137,076 Pat. 6,448,531 Pat. 6,737,608
Pat. 6,284,995 Pat. 6,486,438

See videos & more on this system at: www.BoreRepair.com



8/2020

PO Box 59
Alstead, NH 03602 USA

Tel: (603) 835-2409
Fax: (603) 835-2609

BRS6 ONE-STEP INTEGRATED COMPLETE BORE REPAIR SYSTEM

Popular for large diameter heavy equipment bore repair



**BOA408i
Borewelder**



**BB6 Boring
Bar**

&

The Bore Repair Systems, Inc. BRS6 bore repair packages are selected by customers who have large diameters to repair, generally from 2.5" up to as large as 24". The bore welder and boring bar feature the popular, mount anywhere pass-through drive systems. On bores where there may be restricted access, or bores that are spaced far apart, the pass-through drive design gives you the flexibility to mount where it makes the most sense, such as between the bores. On jobs such as payloaders lift arm bores, the BOA-408i can be center-mounted and can weld out either end of the machine with one simple operation, without ever losing system center...this is unique to the BOA-408i design. On blind bores, our systems do not require special cumbersome remote mounting kits or various length bars because with our pass-through design the excess bar simply comes out of the back end of the machine. The BRS packages share one mount for boring and welding which allows fast setup and rapid transitions from boring to the welding process.



MODEL: BRS6

Bore welding / machining package— for 1.5" to 24.0" dia repairs

- Bore welding head, 110v or 220v drive with variable feed direction and RPM
- Extendable, reversible welding shaft with 90" total extended reach from bore to bore (expandable)
- 10' 150amp welding conduit with universal end (hi-amp upgrades are available)
- Custom aluminum and wooden case
- Spare nozzle, tip and diffuser assortment
- Arc-resistant heatsink style adjustable welding heads & extensions with quick-connect
- Tool kit for both bore welding system and boring bar
- Setup manuals & dvd
- Remote weld trigger for partial bore welding or skipping over no-weld areas
- Fully 360 degree adjustable mounting system enabling control placement where it is most convenient
- Boring bar drive, 110v or 220v drive with variable feed direction RPM and variable feed rate (hydraulic or air power options also available)
- 72" long x 2.25" dia. Bar with dual 1/2" tool ports— enabling easy bore measurements w/out tool removal
- Centering kit with unique aluminum split finned feature enabling installation and removal in tight spaces
- Two auxiliary spherical self-aligning bar support bearings each of which can also support the feed unit
- Sharpened 1/2" square high-speed tool (carbide optional)
- Bore welder to boring bar interface package enables bore welder to mount directly to boring bar bearings or support
- Modular axial feed box can be mounted independently of the rotational head if desired or required.
- 72" long x 1.25" dia bar with drive reducers & small cones
- Boring bar tool extender kit for sturdy tool holding when machining larger bores
- Corrosion-resistant materials used throughout both boring and welding system for years of shop and field reliability

TIP: As your system capabilities needs increase, add large bore welding heads, high-amp consumables, outside diameter & face welding & machining longer or shorter bars or the snap ring groove cutting option. Other configurations of the BB6 and bore welding system combination package are available. Contact Bore Repair Systems, Inc. or your local distributor for more details or a custom quote.

MICRO GUN (for 308i) - A138
MICRO GUN (for 408i & M1) - A336
 Diameter range: .8 to 2" (20 to 51mm)

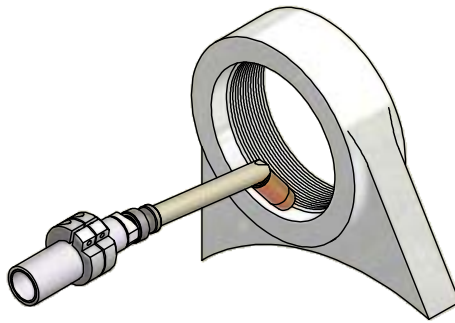

STANDARD GUN (for 308i) - A113
STANDARD GUN (for 408i & M1) - A313
SHORT GUN (for 408i & M1) - A328

Standard Guns Diameter range: 1.25 to 8" (32 to 203mm)
 Short Gun Diameter Range: 1.25 to 4" (32 to 101mm)
 Short Gun 3" (76mm) shorter than standard for use in tight locations.

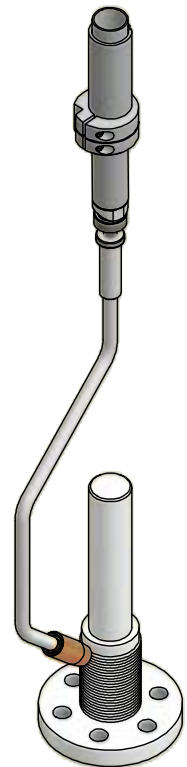

OD GUN (for 308i) A114
OD GUN (for 408i & M1) A317
 Diameter range: 1 to 12" (25 to 305mm)
 Custom sizes available

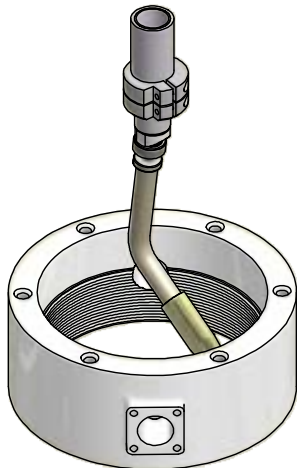

FEATURES OF ALL OF OUR GUNS:

- Quick install on BOA-308i, 408i, 450HD, M1 & L34 Bore Welders
- High electrical & thermal conductivity to help maintain an efficient and safe operating temperature
- Lightweight aluminum construction
- Weld in any position
- Covered by several USA Patents
- Electrical isolation of nozzles and use of standard tips for all bores larger than 1.2" (30mm)

HI-AMP GUN (for 308i) A135
HI-AMP GUN (for 408i, M1 & L34) A344
 Minimum Diameter - 4" (101mm)

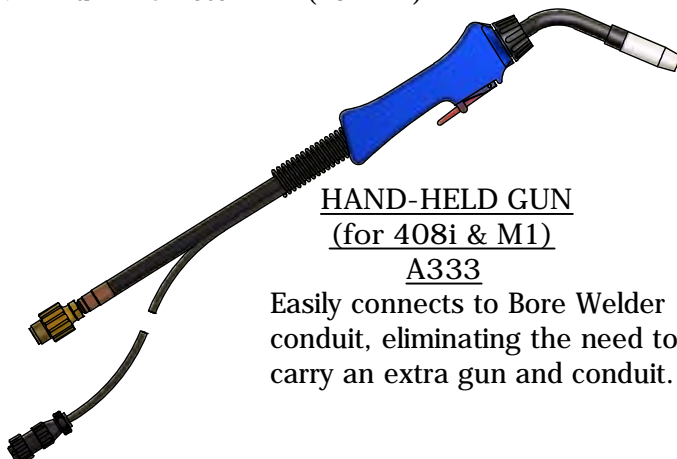

HAND-HELD GUN (for 408i & M1) A333

Easily connects to Bore Welder conduit, eliminating the need to carry an extra gun and conduit.

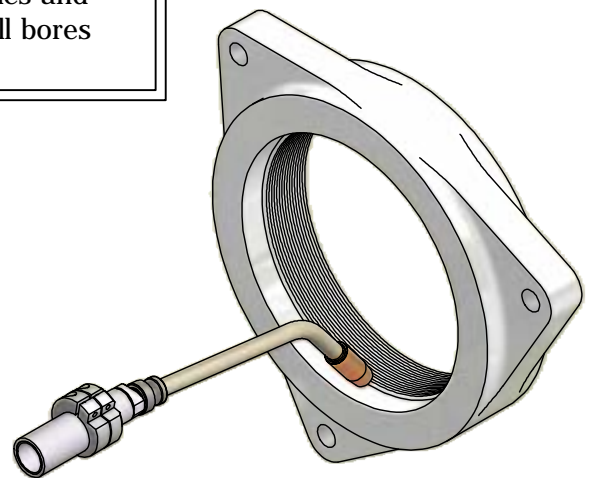

LARGE DIAMETER GUN (for 308i) A115
LARGE DIAMETER GUN (for 408i & M1) A310
 Diameter range: 8 to 15" (200 to 380mm)
 Diameter range with extenders: to 48" (1220mm)

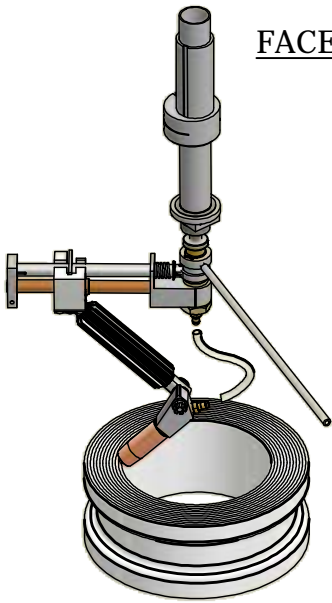

FACE GUN - K13.10

FEATURES:

- Lightweight
- Adjusts easily to the desired welding position
- Weld either inward or outward
- Weld faces up to 24" diameter
- Quick install on 308i, 408i & M1
- High electrical and thermal conductivity to maintain a low operating temperature
- Covered by USA Patent No. 6,486,438 et al

FEATURES:

- Aluminum tube construction makes the torch extremely rigid and durable yet lightweight
- Can weld both ID's and OD's (48" maximum)
- Quick install on 308i, 408i & M1
- High electrical and thermal conductivity to maintain a low operating temperature

BEAM GUN - K13.11



GUN DIAMETER EXTENSIONS K13.12

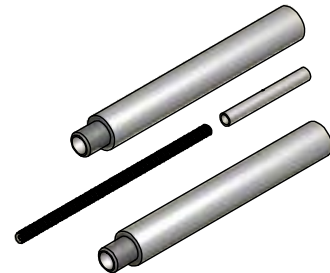

FEATURES:

- Comes with 2 extensions
- Each extension adds 5" (127mm) to the maximum diameter capability of the gun
- Gun liner removal not required
- Use with Large Diameter Gun

GUN REACH EXTENSIONS

A309 [6" (152mm)]

A335 [10" (254mm)]

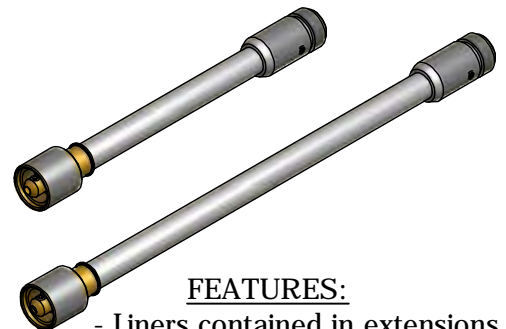

FEATURES:

- Liners contained in extensions
- Can be used with all guns on 408i and M1 machines
- Quick connection and angular orientation with captive nuts
- Constructed with light, highly conductive aluminum with brass fittings

BORE WELDER SUPPORT OPTIONS

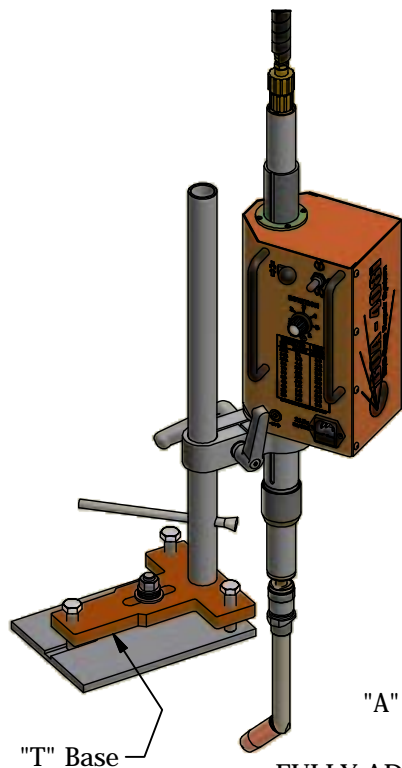

BOA-M1 - Hand
Powered Version

"A" Base

FULLY ADJUSTABLE BASES

"T" BASE (for 408i) - K11.11

"A" BASE (for M1) - K31.21

Allows full adjustment to bore:

- Leveling
- Centering

Also repeatable angular positioning

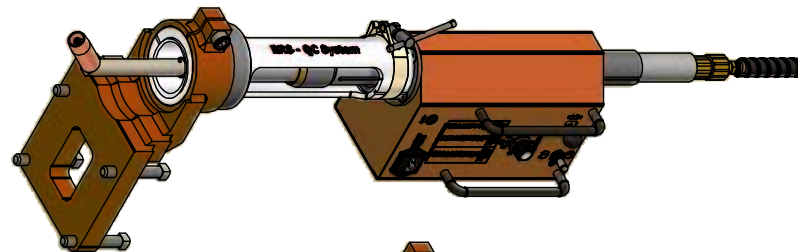

QUICK CONNECT CENTER SUPPORT KIT for BOA-408I - K11.21 | for BOA-M1 - K31.11

- Set-up quickly with no guesswork
- Centers directly from boring bar bearing mounts
- Adjustments made directly using off-set dial

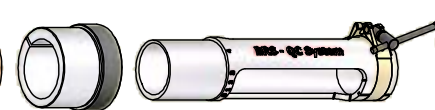
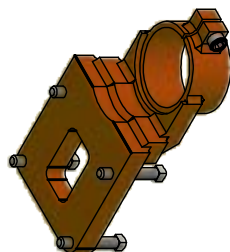

Quick Connect Center Support Kit - Exploded View



UNIVERSAL HEX MOUNT for BOA-M1 - K31.10

- Compact and easy to use
- Can be aligned directly from boring bars

BOA-M1 - Powered Version

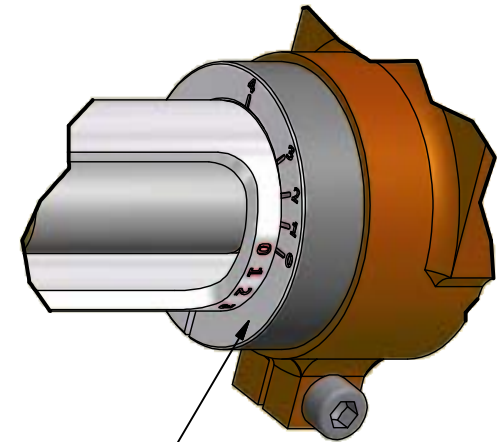

DETAIL A

Off-Set Dial

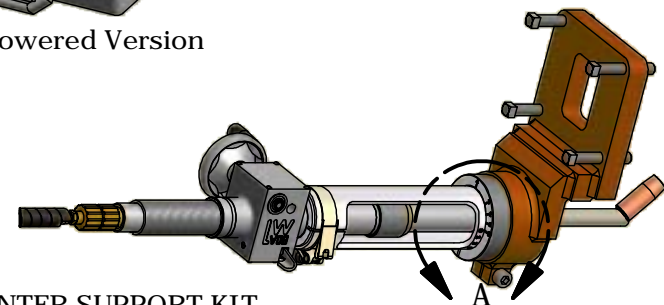

BORE MEASURING KIT K92.10

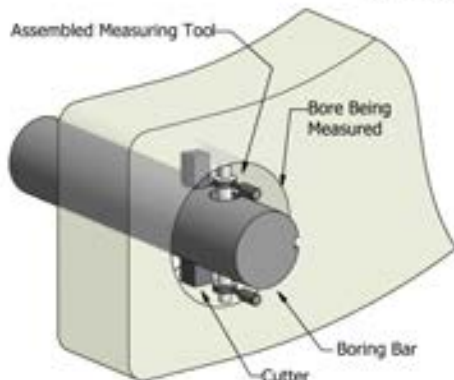

Easy to Use:

1. Insert measuring tool through a tool hole in the boring bar
2. Extend the tool into the bore
3. Snap open the measuring tool
4. Retract the bar
5. Measure the tool length

FEATURES:

- > Kit Diameter Range - 1.7 to 14 inches (42 to 355mm)
- > Additional spacers available for larger diameters
- > Works in 3/8 and 1/2 inch, and 10, 12, 16mm tool holes
- > Durable large diameter plungers
- > Stainless steel construction
- > No tools needed for most bores
- > Comes in durable case with special nesting and adapters for two tooling sizes

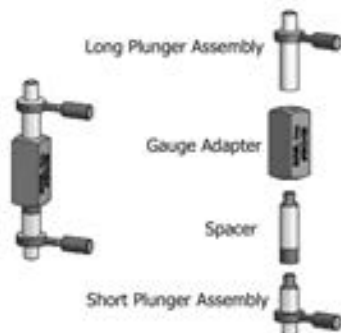

TIGHT BORE MEASURING KIT K92.20

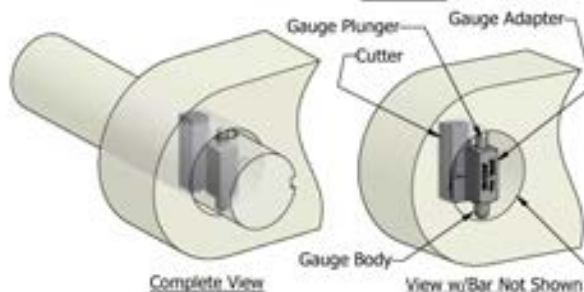

FEATURES:

- > Measure bore diameters equal to bar size, to bar size plus .5 inches (12mm)
- > Durable large diameter plungers
- > No tools needed
- > Kits for all bar and tool sizes available

Patent Pending

MULTI-FUNCTION TOOL ADJUSTER

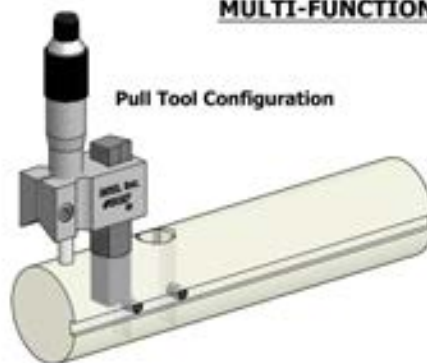

Pull Tool Configuration

Available for the following Tooling Sizes:

1. 1/4" square > K93.10 (Body Only #A903)
2. 3/8" square > K93.11 (Body Only #A904)
3. 1/2" square > K93.12 (Body Only #A905)
4. 10mm square > K93.13 (Body Only #A906)
5. 12mm square > K93.14 (Body Only #A907)
6. 16mm round > K93.15 (Body Only #A908)
7. 3/8" & 1/2" sq > K93.16

All kits include a Tool Adjuster Body, a Barrel Micrometer, a Multi-Function Tool Adjuster Support, and a Carrying Case and Tools

FEATURES:

- > Accurate tool depth adjustment
- > Allows tool removal and replacement to the same cutting depth
- > Allows either pull or push adjustment for both dual and single tool hole bars
- > Clamp to tool or Support from either side
- > Machined "V" provides accurate alignment for single tool hole bars

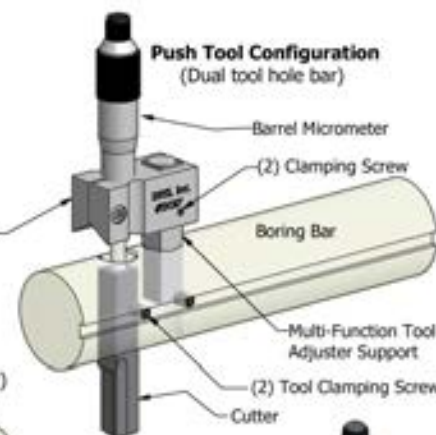
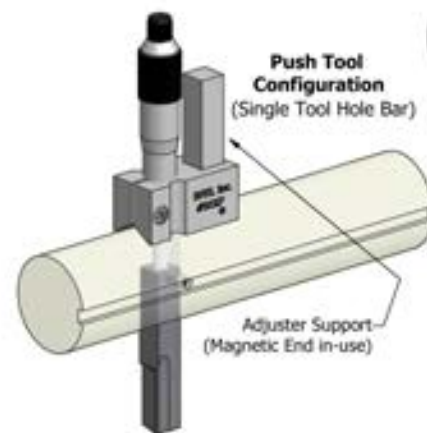

Digital Micrometer - #9089
(Absolute and relative functions)



CARBIDE TOOLING KIT

FEATURES:

- > Special low-profile design works with Bore Repair K93 tool adjuster
- > Available in 3/8" and 1/2" square
- > A variety of carbide grades are available allowing various materials to be machined

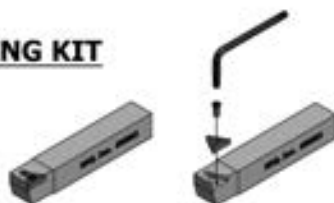

Carbide Bit, Holder and Tool
(Kit includes 2 Bits, Holder and Tool)

3/8" Tool - K91.10 | 1/2" Tool - K91.11

Ultra-Carbide indexable roughing & finish 1/2" tooling Kit #K91.14

PRE-SHARPENED HIGH-SPEED STEEL BITS

FEATURES

- > Wide cutting edge allows both ID and spot facing for easy face touch-up
- > Design of the grind offers easy sharpening using a standard bench grinder
- > Special grind for longer edge life and cleaner cut



3/8" Square Bit - #9088 | 1/2" Square Bit - #9087

1/4" Square Bit - #9085

**BORE REPAIR
SYSTEMS, INC.**
www.borerepair.com
(800)650-1005
(603)835-2409

BORING BAR SUPPORT KIT (K94.20)*

KIT INCLUDES:

(2) A910 Drive Support
& Spherical Support
Adjuster Plate Assemblies



Set-Up Steps:

1. Tack weld or clamp the Adjuster Plate Assemblies adjacent to the bores to be repaired. (The plates should be approximately perpendicular to the bore axis, and with the clamping bolt 5" from the bore centerline.)
2. Attach the Drive Support as shown, and the Spherical Support (not shown) to the Adjuster Plate.
3. Adjust as necessary using the "jack" bolts to achieve the desired bore alignment.
4. Insert the Alignment Sleeve into the Drive Support as shown.
5. Slide the Boring Bar through the Alignment Sleeve and the Spherical Support.
6. Tighten the Strap Clamp.

Kit Assembled on Drive-End

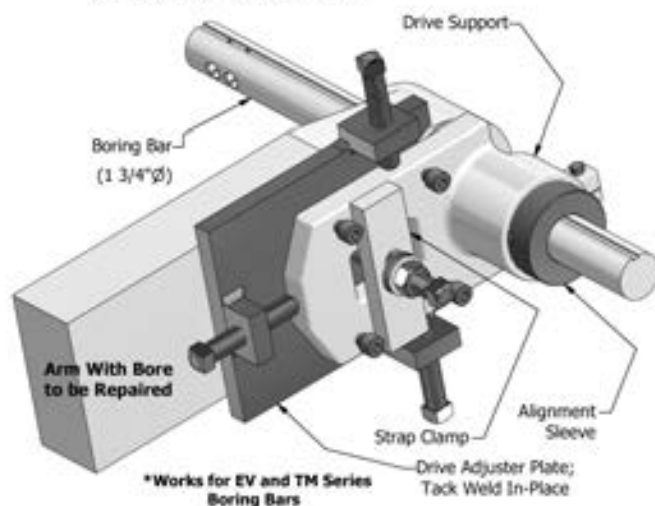

BORING BAR ALIGNMENT KIT



Set-Up Step #1:

1. Assemble 2 sets of Rings, Standoffs, and Screws as shown.
2. With the Rings on the Boring Bar, tack weld Standoffs to the Bore Faces so that the Rings are approximately centered.

FEATURES

- Low Profile
- Easy Alignment to Other Bores
- Allows Precision Alignment
- Great for Alignment to Out-of-Round Bores

Set-Up Step #2:

1. Retract the Adjuster Screws from the Threaded Holes in the Adapter Ring and rotate the Adapter Ring until the Adjuster Screws are no longer aligned with the Threaded Holes.
2. Align the Boring Bar as required using the Adjuster Screws. (If the Bore is round, it is sometimes helpful to insert a Cutting Tool and measure the distance from the Cutting Tool to the Bore in order to assure proper alignment.)



FOR THE FOLLOWING SIZE BARS

1 1/4" Bars	1 3/8" to 5 1/2" Bores	K94.10
1 3/4" Bars	1 7/8" to 10" Bores	K94.11
1 1/4" & 1 3/4"	1" to 10" Bores	K94.12
2.0" Bars	2 1/8" to 10" Bores	K94.13
2 1/4" Bars	2 3/8" to 10" Bores	K94.14

ID GROOVE CUTTER



FEATURES

- Cutter fits in 1/2" tool holes in boring bars
- High speed steel cutting bits
- Cuts grooves in bores from 2.5" to 6" (64 to 152mm)
- Very compact - can be used in confined spaces

FOR THE FOLLOWING BAR SIZES

1 1/2" Bars	K96.10
1 3/4" Bars	K96.11
2" Bars	K96.12
2 1/4" Bars	K96.13



BORE REPAIR SYSTEMS, INC.
web: borerepair.com

(800)650-1005 & (603)835-2409



www.borerepair.com - 800-650-1005 or 603-835-

One-arm multi-mount support
Offers a variety of mounting options
plus handy time saving built-in X-Y and leveling adjustability

Order kit # K94.49



This kit includes necessary hardware, (2) mounting blocks, tack plate, center ring and clamping block.

Bearing inserts are sold separately.

Bearing insert part numbers are #A922 for the 1.75" diameter bar and #9233 for the 2.25" diameter bar



Tack-bars installed

Mount the supports with the tack-bars for large diameter work, or when extra clearance is required for face cutting or groove cutting. The tack-bars may be mounted horizontally or vertically depending on individual job requirements. Standard height bars shown. Optional tall bars are also available. All bars now allow fine tuning with included level screws.



Mount the supports with the tack-plate for smaller diameter jobs or when extra clearance is not needed. The same tack-plate may be used for the standard one-arm supports as well.



Tack-plate installed

Shown with #A922 bearing



Shown supporting the BB6





www.borerepair.com - 800-650-1005 or 603-835-

Compact circular support

Offers many mounting options. Great for tight spaces or for adding additional boring bar, bore welder or boring bar drive support when desired.

Order Kit #K94.50

Offers X-Y and leveling adjustment after being mounted to workpiece.



This kit includes the necessary hardware , (3) extension arms and center ring assembly.

Bearing inserts are sold separately.

Bearing insert part numbers are #A922 for the 1.75" diameter bar and #9233 for the 2.25" diameter bar

Shown supporting the BOA-C45 (left) and with #A922 bar support bearing (right)



For added bar rigidity and support, add the #K94.50 compact circular support with bearing insert to the #K94.49 one-arm support as shown





www.borerepair.com - 800-650-1005 or 603-835-2409

Ultra-Carbide Indexable

Order kit # K91.14

Line-boring cutter kit for 1/2" tool ports



Insert holder #9476 is 3 inches long—can be ordered shorter if required for your job.

The Bore Repair Systems, Inc. Ultra-Carbide indexable line bore cutter kit is our newest design in cutting bit kits.

- Features:**
- Low-profile tool pocket—enables the cutter to slide entirely through the bar
 - Enables faster rotation speeds than standard high speed steel bit
 - Can be used for entire job, not just finishing. The Ultra-Carbide bit withstands rough cuts, interrupted cuts and harder material
 - Stays sharp up to 10x longer than high speed steel bits, and is tougher than cemented carbides and traditional carbide inserts
 - 3 cutting edges, helping to keep you on the job not sharpening the tool
 - Holder may be heat hardened if desired

Kit includes 1 each: #9476 insert holder, #9475 insert, #9477 torx screw and #9478 flag wrench

Bore welder packages



BOA-408i S5 System	BOA-408i S4 System	BOA-408i S3 System
Standard Capabilities: I.D. Weld range: 20mm-1.2m (.8-48") O.D. Weld range: 20mm-1.02m (.8-40") Face Welding: 20-610mm (.8-24") diameter Stroke: 318mm (12.5") Pass-thru & telescopic Long-duration welding at high amperage Auto-weld skip for partial bore welding Can weld in compact spaces (use BOA-M1 drive) Can weld two bores at once (2 feeders needed)	Standard Capabilities: I.D. Weld range: 20mm-914mm (.8-48") O.D. Weld range: 20mm-914mm (.8-36") Face Welding: 20-610mm (.8-24") diameter Stroke: 318mm (12.5") Long-duration welding High amperage operation Pass-through gun drive with tool-less telescoping feature and full, tool-less reversibility	Standard Capabilities: I.D. Weld range: 20mm-914mm (.8-31") O.D. Weld range: 20mm-305mm (.8-12") Face Welding: 20-610mm (.8-24") diameter Stroke: 318mm (12.5") Long-duration welding High amperage operation Pass-through gun drive with tool-less telescoping feature and full, tool-less reversibility

Standard equipment:	Standard equipment:	Standard equipment:
Welding gun drive 120v/240v AC automatic	Welding gun drive 120v/240v AC automatic	Welding gun drive 120v/240v AC automatic
Long stroke telescopic ball spindle	Long stroke telescopic ball spindle	Long stroke telescopic ball spindle
Standard weld gun assembly	Standard weld gun assembly	Standard weld gun assembly
Heavy duty conduit with remote weld switch	Heavy duty conduit with remote weld switch	Standard conduit with remote weld switch
Standard gun extension tube assembly	Standard gun extension tube assembly	Standard gun extension tube assembly
Micro weld gun assembly	Micro weld gun assembly	Micro weld gun assembly
Weld gun extensions, 152 & 254mm (6 & 10")	Weld gun extensions, 152 & 254mm (6 & 10")	Weld gun extensions, 152 & 254mm (6 & 10")
Bore welder support tube	Bore welder support tube	Bore welder support tube
Radial support arm	Radial support arm	Radial support arm
Necessary tools	Necessary tools	Necessary tools
Deluxe consumables kit	Deluxe consumables kit	Standard consumables kit
Diamond plate carry case	Diamond plate carry case	Diamond plate carry case
Users and setup manual	Users and setup manual	Users and setup manual
Outside diameter welding gun	Outside diameter welding gun	Outside diameter welding gun
Adjustable "T" base and tack plate kit	Adjustable "T" base and tack plate kit	Adjustable "T" base and tack plate kit
Large diameter welding gun	Large diameter welding gun	Large diameter welding gun
Large diameter welding gun extenders (2)	Large diameter welding gun extenders (2)	Large diameter welding gun extenders (2)
Radial extenders for large diameter reach (3)	Radial extenders for large diameter reach (2)	Radial extenders for large diameter reach (2)
Face welding gun kit	Face welding gun kit	Face welding gun kit
Handheld welding gun with quick connect	Handheld welding gun with quick connect	Handheld welding gun with quick connect
Beam gun kit for large ID and OD welding	Beam gun kit for large ID and OD welding	
Low-speed kit for precision control in large bores	Low-speed kit for precision control in large bores	
BOA-M1 compact bore welder		
Hex BOA-M1 borewelder support kit		
Compact gun extension tube assembly		
Standard conduit assembly		
Short telescopic ball spindle		
Stub weld gun assembly		
Auto-Skip feature installed for partial bore weld		
Order #K01.50	Order #K01.40	Order #K01.30

NOTE:
All BOA-408i bore welder systems feature the pass-through drive system design. This enables simple bore-to-bore transitions by simply telescoping or retracting the bore welder gun extension assembly. The BOA-408i may also be mounted between a set of bores, and can weld on either end of the bore welder. This is a very handy feature for working on bores such as those found on the front of a pay loader because by center mounting the BOA-408i drive, only one setup is required to weld both left and right side bores. Diameter adjustment is a snap with the BOA torch pivot mechanism, also included with all BOA-408i bore welder systems.

All BOA-408i bore welder systems may be equipped with the bore welder to boring bar interface for true plug and play simplicity. Once the Bore Repair Systems, Inc. boring bar is set up, the bore welder simply plugs in to the boring bar support.

All BOA-408i bore welder systems feature self-lubricating, maintenance-free, self lubricating spindle bearings, clutched chain drive and simple, durable on-board control eliminating the need for control cables or control box.

Covered under Pat. Nos 6,137,076; 6,448,531; 6,737,608; 6,284,995; 6,486,438



Bore Repair Systems, Inc.
 97 Lower Cemetery Road
 Langdon, NH 03602 USA
 Borerepair.com - 603-835-2409
 Fax: 603-835-2609

BORER REPAIR
Systems, Inc.
www.borerepair.com
(603) 835-2409 • (800) 650-1005

<u>Standard equipment:</u>	<u>Standard equipment:</u>	<u>Standard equipment:</u>
Welding gun positioner 120v/240v AC, automatic	Welding gun positioner 120v/240v A/C, automatic	Welding gun positioner, semi-automatic *
Standard stroke telescopic ball spindle	Standard stroke telescopic ball spindle	Standard stroke ball spindle
Standard weld gun assembly	Standard weld gun assembly	Standard weld gun assembly
Standard conduit with remote weld switch	Standard conduit with remote weld switch	Standard gun extension tube assembly
Standard gun extension tube assembly	Standard gun extension tube assembly	Necessary tools
Micro weld gun assembly	Micro weld gun assembly	Gun rotation handwheel
Weld gun extension 254mm (10")	Weld gun extension, 152mm (6")	Adjustable Hex mounting base kit
Bore welder support tube	Bore welder support tube	Remote control wire feeder contactor
Radial support arm	Radial support arm	Rotation speed timer tool
Necessary tools	Necessary tools	User's and setup guide
Standard consumables kit	Standard consumables kit	Carry case with custom nesting
Diamond plate carry case	Diamond plate carry case	Standard consumables kit
Users and setup manual	Users and setup manual	
Adjustable "T" base and tack plate kit		
Large diameter welding gun		
8" Radial extender for large diameter reach		
Handheld welding gun with quick connect		
		*Power Stepper drive kit #K33.21 available
Order #K01.20	Order #K01.10	Order #K03.10

Bore Repair Systems, Inc.
97 Lower Cemetery Road
Langdon, NH 03602 USA
Borerepair.com - 603-835-2409
Fax: 603-835-2609

Boring Bar Packages



Model BOA-C45 Linebore Package

Core Package Diameter range is 1.9" -10" (48 to 254mm) Includes:

- 3.3 HP variable speed motor w/4 speed transmission
- 72" (1.8 m) x 1.75" chromed internally couplable bar with dual tool ports
- Pass-through bar drive w/ quick connect feed screw
- Set-up cylinder for locating and aligning multi-mount
- (2) Mount plates for anchoring dogleg support
- Disengagable bar feed mechanism for quick feed adjustment
- Automatic in-feed crash protection
- Trouble-free spline connection between motor and gearbox
- (2) HSS, 5% cobalt cutters
- Speed range of 15 to 270 RPM and reversible feed
- Variable rate axial feed
- (2) One-arm dogleg bar/drive / bore welder support
- (1) Bar support bearing insert (precision tuneable)
- Tool extension, for bores 6"-10" (152-254mm)
- Removable axial feed screw
- Rugged lockable carrying case
- Allen wrench set with tool pouch
- Centering kit including tensioning system for centering system in bores 1.9" to 10" (48 to 254mm)
- Graphical set-up manual with full parts list

(order kit no: K09.02)

Optional accessories for the BOA-C45 line bore system include several face machining options, snap-ring groove cutting kit, ultra-carbide indexable cutting system, thru-bar bore measure kit, digital and non-digital precision tool adjusters, small and micro bar kit (enabling boring in diameters down to 1" (25mm) , extended range boring head for bores up to 14" (356mm) , hydraulic drive option, automatic or semi-automatic bore welding options and more. See accessories list for full range of available options.

Model BB- 6 Linebore Package

Core Package Diameter range is 1.4" -24" (36 to 610mm) Includes:

- 3.3 HP variable speed motor w/4 speed transmission
- 72" (1.8 m) x 2.25" bar with dual tool ports
- (2) HSS, 5% cobalt cutters
- (2) Set-up blocks for adjustable supports
- Large diameter tool extender – to 24" (619 mm)
- Dis-engagable bar feed gearbox with remote mount capability
- Automatic in-feed crash protection
- Trouble-free keyed connection between motor and gearbox
- Custom wooden storage case
- Speed range of 10 to 170 RPM and reversible feed
- 72" (1.8 m x 1.25" chromed bar with dual tool ports
- (2) Adjustable one arm offset bar and welder supports
- Adjustable compact bar and welder support
- Centering cone set – 1.4 to 14" (35 to 356 mm)
- Easily removable feed screws – available in several lengths
- Infinitely variable feed rate
- Instructional set-up manual with photos
- Tool set with tool box

(order kit no: K09.15)

Optional accessories for the BB-6 line bore system include several face machining options, snap-ring groove cutting kit, ultra-carbide indexable cutting system, thru-bar bore measure kit, digital and non-digital precision tool adjusters, automatic or semi-automatic bore welding options and more. See accessories list for full range of available options. Hydraulic drive option is also available.



Combo Boring & Welding Packages



- Welding / Boring systems below share the same mount for easy one-step setup and boring to welding transitions
- Systems below all feature dual tool / accessory ports on bar. This feature, when used with snap gage and digital tool adjuster gives you the easiest and most accurate means of measuring the bore with the tool bit and bar still in place, and the most accurate way to adjust your tool bit for precise final cuts with .0001" precision.
- Many systems below feature the centering cone tightener kit. This unique kit makes the job of centering your bar and keeping the cones tight by yourself a breeze. Kit includes its own allen spin tight wrench.
- All systems below feature the unique pass-through drive design. This design, unlike the old fashioned end-mounted designs of other brands offers users far superior setup versatility. The pass-through design is excellent for bores that are spaced far apart and for parts that have blind bores. These bores are commonly found on construction machinery.
- All packages below may be customized as you need. Packages below may swap the BOA-408i for the BOA-M1 for \$2875. pkg. discount
- All systems below feature adjustable bar support bearings—ensures bars slide through supports bearings with ease

MODEL	COMBINATION BORE WELDING & MACHINING KIT DESCRIPTIONS	KIT NO. / DESCRIP
BRS2c (Electric drive)	BORING SYSTEM MODEL: BOA-C45 <i>Pass-Thru Drive Electric</i> - FOR BORES 47-254mm (1.8-10") DIA KIT DESCRIPTION: Bar included: (1) Chromed 1 3/4"Ø x 72" long w/ dual tool holes, 115v or 220v, <u>Hi Torque 3.3 hp. Reversing Var. Elec. Drive (15-270 RPM)</u> with reversing feed mechanism, centering cone set w/ tightener kit, 2 spherical bar support bearings, 3 machine supports, steel jobber box, tool bit, BOA-408i bore welder package w/center support kit. (upgradable drive can run 7/8" and 1.25" dia bars) OPTIONS AVAILABLE: Thru-bar measuring tool, carbide insert tool package, small bar options (for boring down to 1" or 1 3/8" Ø (depends on kit selected) , facing tool, digital tool adjuster kit, snap-ring groove cutter, extended diameter range cutting heads, tapered bars for blind end-drilling/milling operations	(Comes with BOA-408i bore welder and direct mount interface) <u>Order # K05.109902</u>
BRS3c (Electric drive)	BORING SYSTEM MODEL: BOA-C45 <i>Pass-Thru Drive Elec.</i> - FOR BORES 35-254mm (1.4-10") DIA KIT DESCRIPTION: 2 Bar set:: (1ea.) 1 3/4" & 1 1/4"Ø Chrome Bars x 72" long w/ dual tool ports, 115v or 220v, <u>Hi Torque 3.3 hp. Reversing Var. Elec. Drive (15-270 RPM)</u> with reversing feed mechanism, centering cone set w/ tightener kit, 2 spherical bar support bearings, 3 machine supports, steel jobber box, machine mount, 2 tool bits, BOA-408i bore welder package w/center support kit. . (upgradable drive can run 7/8" dia bar kit for small diameter boring) OPTIONS AVAILABLE: Thru-bar measuring tool, carbide insert tool package, small bar options (for boring down to 15/16" Ø, facing tool, custom length bars & tool ports, digital tool bit adjuster, snap-ring groove cutter, extended diameter range cutting heads, tapered bars for blind end-drilling/milling operations.	(Comes with BOA-408i bore welder and direct mount interface) <u>Order # K05.109903</u>
BRS4c (Electric drive)	BORING SYSTEM MODEL: BOA-C45 <i>Pass-Thru Drive Elec.</i> - FOR BORES 24-254mm (1-10") DIA KIT DESCRIPTION: 3 Bar set:: (1ea.) 1 3/4"&1 1/4" Ø Chrome Bars x 72" long w/ dual tool ports, (1) 7/8"Ø Chrome Bar x48", 115v or 220v, <u>Hi Torque 3.3hp. Reversing Var. Elec. Drive (15-270 RPM)</u> with reversing feed mechanism, centering cone set w/ kit, 2 spherical bar support bearings, 2 machine supports, steel jobber box, adj. machine mount, reducer kits for 1.25" and 7/8" bars, centering cones for all bar sizes w/ tightener kit plus 3 tool bits, BOA-408i bore welder package w/center support kit. OPTIONS AVAILABLE: Thru-bar measuring tool, carbide insert tool package, facing tool, digital tool adjustment kit, snap-ring groove cutter, extended diameter range cutting heads, custom length bars & tool ports, morse tapered bars for blind end-drilling/milling operations.	(Comes with BOA-408i bore welder and direct mount interface) <u>Order # K05.109904</u>
BRS6 (Electric drive)	BORING SYSTEM MODEL: BB 6 <i>Pass-Thru Drive Electric</i> FOR BORES 36-610mm (1.4-18") DIAM. (expandable to over 610mm (24") Diameter capability) KIT DESCRIPTION: 2 1/4"Ø Bar x 72" long, 1.25"Ø Bar x 72" long w/dual tool ports , 3.3 hp electric drive option, alignment cones, tooling, tool extensions , 3 adjustable bar/machine supports, tool kit & custom wooden box & borewelder case, BOA-408i bore welder package w/bore welder adapter kit. OPTIONS AVAILABLE: Lg. bore kit (up to 24"Ø), facing head, carbide tooling kit, pneumatic drive, 2.5hp hydraulic drive, custom length bars, digital tool adjustment gage, ID bore measuring gage kit, snap ring groove cutting kit. (also available without 1.25" dia bar package—call for price)	(Comes with BOA-408i bore welder and direct mount interface) <u>Order # K05.109915</u>

-All systems above are standard electric drive kits. Prices reflect 120v. For 240v, price is \$300 higher.

-All systems above may be upgraded to 120v or 240v hydraulic drive if desired. Inquire for price quote.

Covered under Pat. Nos 6,137,076; 6,448,531; 6,737,608; 6,284,995; 6,486,438







Bore Repair Systems, Inc.
97 Lower Cemetery Road
Langdon, NH 03602 USA
www.borerepair.com - 603-835-2409

*-subject to change. Call for quote or email to: sales@borerepair.com

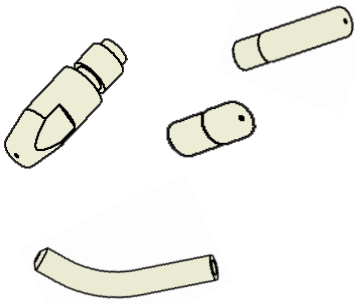
Consumable parts (welding)

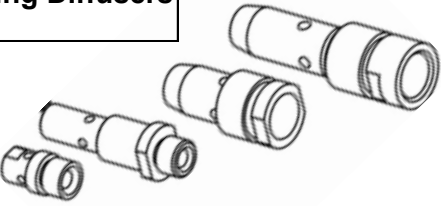

Welding Tips		Stub tip, .8mm (.030") Stub tip, .9mm (.035") Stub tip, 1.2mm (.045") Standard tip, .8mm (.030") Standard tip, .9mm (.035") Standard tip, 1.2mm (.045") Hi-amp tip, .9mm (.035") Hi-amp tip, 1.2mm (.045") Hi-amp tip, 1.3mm (.052") Micro-gun tip, .8mm (.030")	#1058 10 per pk #1059 10 per pk #1060 10 per pk #1061 10 per pk #1062 10 per pk #1063 10 per pk #2040 10 per pk #2041 10 per pk #2042 10 per pk #1255 10 per pk
Welding Nozzles		Mini nozzle, insul. ceramic 32-50mm (1.25-2.00") Mini nozzle, brass 32-50mm (1.25-2.00") Stub nozzle (use for dia. to 50mm (2.00")) Standard nozzle (use for dia. Over 127mm (5.0")) Hi-amp nozzle (for use on beam & hi-amp gun) Hi-amp stub nozzle (use on beam & hi-amp gun) Micro-gun nozzle body Hand-held gun nozzle	#1092C 10 per pk #1092B 10 per pk #1066 5 per pk #1067 5 per pk #2067 5 per pk #2074 5 per pk #1258 Sold each #1308 5 per pk
Welding Diffusers		Mini diffuser (9mm) Standard diffuser (9mm) Hi-amp diffuser (12mm) Hi-amp stub diffuser (12mm) Hi-amp diffuser to gun adapter, 9-12mm Hi-amp diffuser to gun adapter	#1093 10 per pk #1057 5 per pk #2068 5 per pk #2075 5 per pk #1251 Sold ea #2080 Sold ea
Liner & Conduits		Liner, conduit replacement Liner (1.5m (5') section, trim to fit) Conduit assembly, standard duty QC Conduit assembly, heavy duty QC Conduit assembly, extra heavy duty QC	#1038 Sold ea #1039 Sold ea #A315 Sold ea #A337 Sold ea #A338 Sold ea
MIG Welder, Etc.		Micro inverter welder / feeder kit 120/240v Adapter kit to connect MIG feeder to borewelder	#K15.10 Sold ea #1120 Sold ea
<i>(K15.10 kit comes w/conduit, cords, stinger, ground cable and gas regulator with hose)</i>			

Covered under Pat. Nos 6,137,076; 6,448,531; 6,737,608; 6,284,995; 6,486,438



Bore Repair Systems, Inc.
97 Lower Cemetery Road
Langdon, NH 03602 USA
Borerepair.com - 603-835-2409
Fax: 603-835-2609

Borewelder parts & acc.



Welding Guns		Gun, short QC	#A328
		Gun, standard QC	#A313
		Gun, micro QC for ID's 20-50mm (.8"-2.0")	#A336
		Gun, large dia. for ID's 200-380mm (8"-15") QC	#A310
		Gun, outside dia. for 25mm-305mm (1"-12") QC	#A317
		Hi-amp gun	#A209
Specialty Guns		Extra heavy duty gun, ultra hi-amp	#A404
		Heavy duty gun extender	#K23.10
		Face welding gun kit	#K13.10
		Beam gun kit (adjustable ID and OD welding)	#K13.11
		Hand held gun assembly QC	#A333
Gun Extenders		Gun extension assembly 150mm (6")	#A309
		Gun extension assembly 250mm (10")	#A335
		Gun diameter extension kit (125mm (5") x2	#K13.12
		(note: K13.12 only for use with #A310 welding gun)	
Welder Supports		"T" Base with tack plate	#K11.11
		Support tube (for stand-alone borewelder use)	#1351
		Radial support (for BOA408 welder use w/ #1351)	#A148
		Radial support (for BOA M1 welder use w/ #1351)	#A362
		Center support kit (BOA-M1)	#K31.11
		Center support kit (BOA-408i)	#K11.21
		Radial support extension 102mm (4")	#A118
		Radial support extension 204mm (8")	#A119
		Centering cone 45-160mm (1.8-6.4")	#1317
		Centering tube & cone kit 45-160mm (1.8-6.4")	#K11.12
Drive Spindles		Spindle assembly, 250mm (10") (BOA-M1 only)	#A320
		Spindle assembly, 356mm (14")	#A325
		Spindle assembly, 457mm (18")	#A319
		Spindle assembly, 610mm (24")	#A326
		Spindle assembly, 762mm (30")	#A351
Telescoping weld gun Extension Assemblies		Telescoping tube assembly, 305mm (12")	#A339
		Telescoping tube assembly, 483mm (19")	#A316
		Telescoping tube assembly, 610mm (24")	#A340
		Telescoping tube assembly, 915mm (36")	#A341

Covered under Pat. Nos 6,137,076; 6,448,531; 6,737,608; 6,284,995; 6,486,438



Bore Repair Systems, Inc.
97 Lower Cemetery Road
Langdon, NH 03602 USA
Borerepair.com - 603-835-2409
Fax: 603-835-2609

Misc. bore repair parts



BOA 408i upgrades



Low-speed gearset kit	#K12.14
Standard-speed gearset kit	#K12.13
Std/Low-speed gearset kit	#K12.12
Auto-skip upgrade	#A129

Boring bar supports, centering, etc.

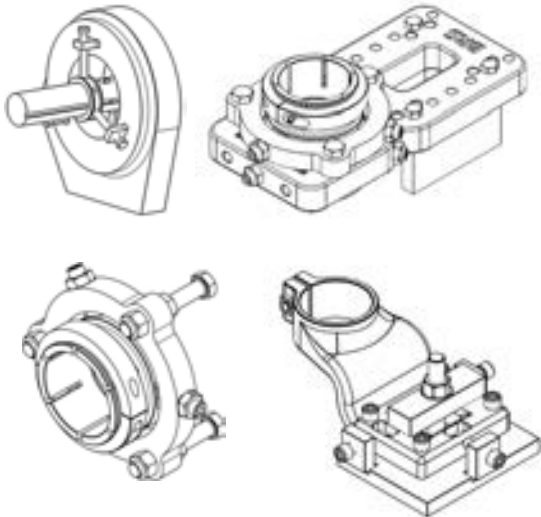

Boring bar base-plate support kit, adjustable	#K94.21
Support, dogleg adjustable one-arm boring bar	#K94.30
Support kit, 2x one-arm w/ coupling hardware	#K94.32
Support, Multi-Mount w/hardware & tack plates	#K94.49
Support, universal compact adjustable circular	#K94.50
Bearing, spherical insert assembly for 1.75" bar	#A922
Bearing, spherical insert for 2.25" bar	#9233
Boring bar align kit (low-profile) for 1.25" dia bars	#K94.10
Boring bar align kit (low profile) for 1.75" dia bars	#K94.11
Boring bar align kit (low profile) for 2.25" dia bars	#K94.14
Tool extender arm, 3" - for 6"-10" dia. boring	#K91.20
Tool extender arm, 5" - for 10" - 14" dia boring	#K91.21
ID bore measure gage, standard model	#K92.10
ID bore measure gage, tight bore model	#K92.20

Boring bar related accessories

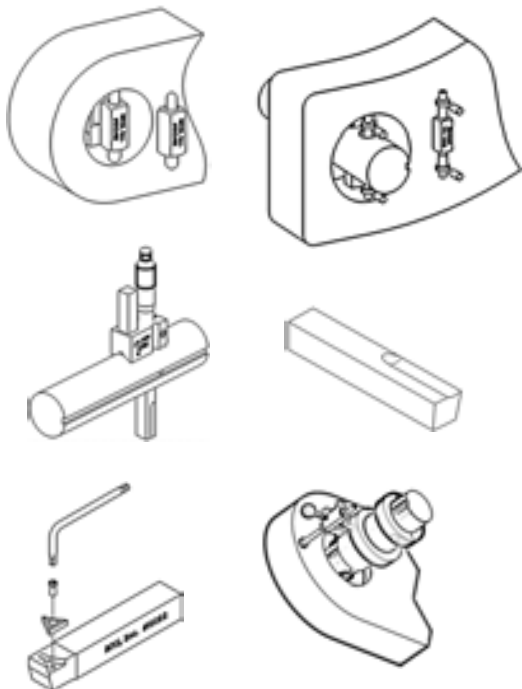

Multi-function tool bit adjuster kit for 1/2" sq.	#K93.12
Multi-function tool bit adj. kit for 1/2 & 3/8" sq.	#K93.16
Tool adjuster body, for 1/4" sq. bits	#A903
Tool adjuster body, for 3/8" sq. bits	#A904
Multi-function tool bit adjuster kit for 1/2" sq. digital	#K93.22
Multi-function tool bit adj. kit for 1/2 & 3/8" sq. digital	#K93.26
Boring bar, 4ft x 1.75" diameter for use with C45	#9352
Boring bar, 8ft x 1.75" diameter for use with C45	#9382
Cutting bit, HSS w/5% cobalt, pre-sharp 1/4" sq.	#9085
Cutting bit, HSS w/5% cobalt, pre-sharp 3/8" sq.	#9088
Cutting bit, HSS w/5% cobalt, pre-sharp 1/2" sq.	#9087
Cutting bit kit, carbide 3/8" sq. lo-pro (#9130 insert)	#K91.10
Cutting bit kit, carbide 1/2" sq. lo-pro (#9130 insert)	#K91.11
Replacement standard (TCMT) carbide insert	#9130
Ultra-carbide cutter kit, 1/2" HD Multi (#9475 insert)	#K91.14
Replacement ultra-carbide insert (10pc = 10% disc)	#9475
Groove cutting kit for 1.75" dia bars, ex model	#K96.16
Groove cutting kit for 2.0" dia bars, ex model	#K96.17
Groove cutting kit for 2.25" dia bars, ex model	#K96.18
Face cutting kit, automatic spiral for 1.75" dia bars	#K96.26
Face cutting kit, automatic spiral for 2.25" dia bars	#9260

Note: Also available for your boring bar systems are various length bars, hydraulic upgrade, face cutter kits for larger bars, two-arm mounting kits, morse-tapered bars (allowing end-of-bar drilling operations and easy coupling) and more. Call us for any of your special applications and requirements.

